

## DG 2840

Built-in steam oven

for healthy cooking with automatic programmes.



- 7-segment display with sensor controls – EasySensor
- Perfect results – DualSteam technology
- Perfect results guaranteed every time – Automatic programmes
- Easy preparation of a complete meal – menu cooking
- Plenty of room – 40 l stainless steel oven compartment

EAN: 4002516156635 / Material number: 11094400 /  
Old Material Number: 23284040GB

<b>General information</b>	
Model identifier	DG 2840
Manufacturer material number	11094400
EAN number	4002516156635
Marketing class	Silver
<b>Construction type and design</b>	
Colour	Stainless steel/Clean Steel
PureLine	•
<b>Construction type and design</b>	
Built-in steam oven	•
<b>Convenience features</b>	
External steam generation	•
Menu cooking without transfer of taste	•
Automatic programmes with ability to make individual adjustments	•
<b>Operating modes</b>	
Steam cooking	•
Eco steam cooking	•
Defrosting	•
Reheat	•
Automatic programmes	•
<b>User convenience</b>	
Display	EasySensor
SoftOpen	•
SoftClose	•
Quantity-independent cooking	•
Steam cooking on up to 3 levels at the same time	•
Menu cooking with steam	•
Steam reduction before end of programme	•
Programmable cooking duration	•
Actual temperature display	•
Individual settings	•
<b>Efficiency and sustainability</b>	
Power rating in off mode in W	0.3
Power rating in standby mode in W	0.8
Power rating in networked standby in W	2.0
Time until automatic switch to standby in min	20
Time until automatic switch to networked standby in min	20
Time until automatic switch to off mode in min	20
<b>Cleaning and care</b>	
Stainless steel/CleanSteel finish	•
Stainless-steel oven compartment with linen structure	•
External steam generator	•
Floor heater for condensate reduction	•
Quick-release side racks	•
Removable stainless-steel side racks	•
Descaling	•
CleanGlass door	•

DG 2840

Built-in steam oven

for healthy cooking with automatic programmes.



EAN: 4002516156635 / Material number: 11094400 /

Old Material Number: 23284040GB

<b>Steam techn./water supply</b>	
DualSteam	•
Fresh water container volume in l	1.5
Removal of fresh water container with Push2release	•
DirectWater	No
<b>Safety</b>	
Appliance cooling system and touch-cool front	•
Safety switch-off	•
Vapour cooling system	•
<b>Technical data</b>	
L oven compartment	•
Oven compartment volume in l	40
No. of shelf levels	4
Door hinge	Bottom
Electronic steam oven temperature regulation min. in °C	40
Electronic steam oven temperature regulation max. in °C	100
Niche width min. in mm	560
Niche width max. in mm	568
Niche height min. in mm	450
Niche height max. in mm	452
Niche depth in mm	550
Appliance dimensions (W x H x D) in mm	595 x 455 x 569
Appliance width in mm	595
Appliance height in mm	455
Appliance depth in mm	569
Weight in kg	26.8
Total rated load in kW	3.60
Voltage in V	230
Frequency in Hz	50-60
Fuse rating in A	16
Number of phases	1
Neutral conductor	Yes
Mains cable with plug	•
Length of supply lead in m	2
<b>Accessories included</b>	
Removable side runners (pair)	1
No. of perforated stainless-steel cooking container	2
Solid stainless steel cooking containers, 40 mm high	1
Wire rack	1
Drip tray DGG 100 40	1
Descaling tablets	2

DG 2840  
Built-in steam oven  
for healthy cooking with automatic programmes.

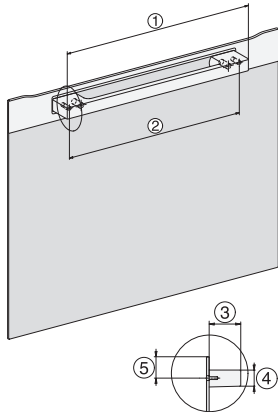

H7000 handle, installation drawing

1) 400 mm, 2) 360 mm, 3) 47 mm, 4) 24 mm, 5) 32.5 mm

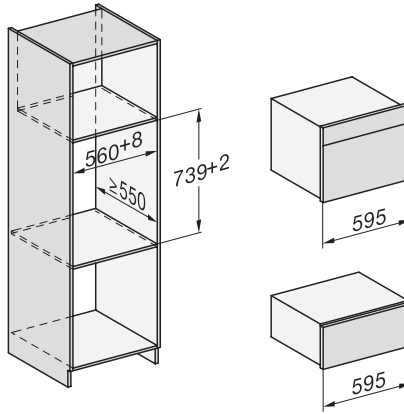

Installation DG, DGM, DGC XL, ESW7x20 installation drawings

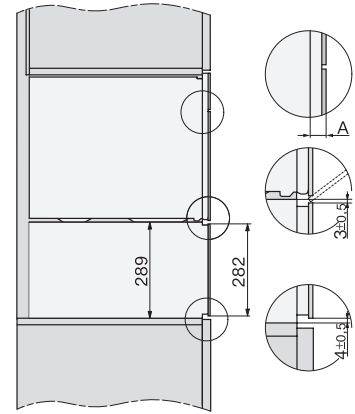

side view, DG, DGM, ESW7x20 installation drawings

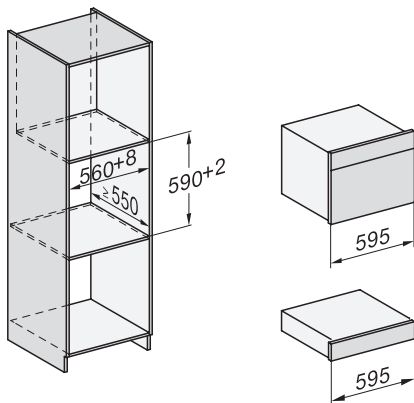

Installation\_DG\_DGM\_DGC\_XL\_ESW7x10\_EVS7010, installation drawings

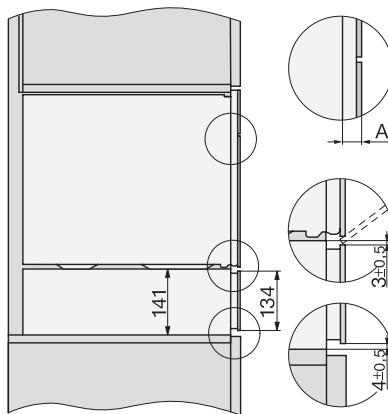

Side view\_DG\_DGM\_ESW7x10\_EVS7010 installation drawings

A) 22 mm glass, 23,3 mm stainless steel

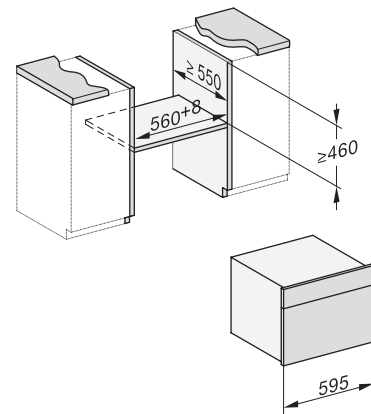

built-in DG DGM DGC XL build-under, installation drawing

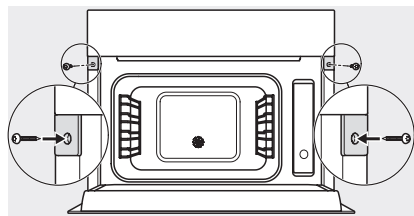

Screw joint DG DGM, installation drawing

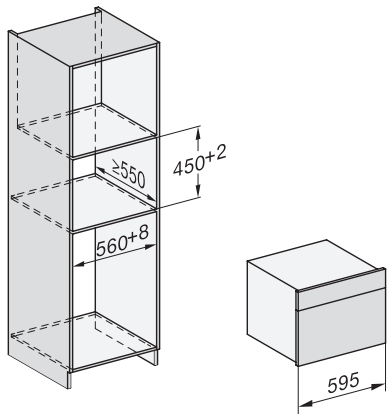

DG DGM, installation drawing

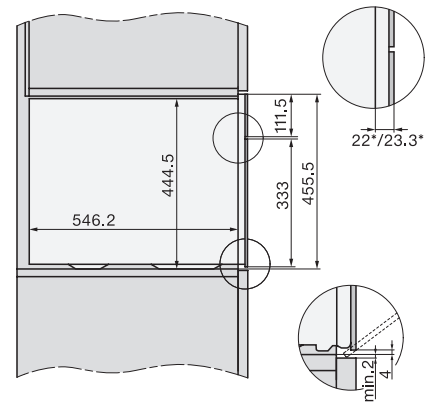

side view DG DGM, installation drawing, GB, AU  
22 mm glass, 23,3 mm stainless steel

DG 2840  
Built-in steam oven  
for healthy cooking with automatic programmes.

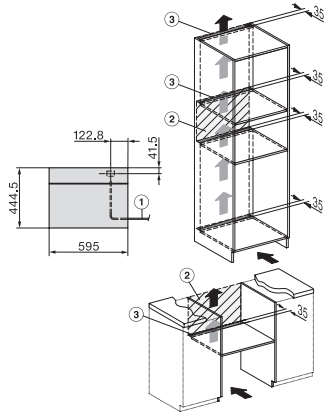

installation DG, installation drawing, GB, AU

1) Mains connection cable, L=2000 mm, 2) No connection in this area, 3) Ventilation cutout min. 180 cm<sup>2</sup>